

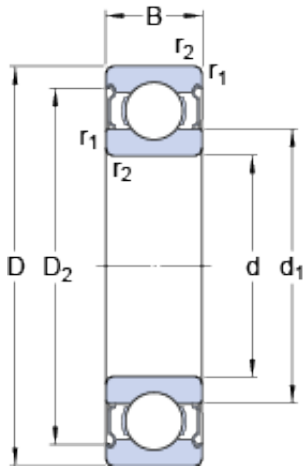

Cylindrical Roller Bearings-VIETNAM C...



6203-2z Bearing 2D drawings and 3D CAD models

SKF 6203-2z Radial Deep Groove Ball Bearing

Bearing No. 6203-2z

Size	40x17x12 mm
Bore Diameter	40 mm
Outer Diameter	17 mm
Width	12 mm
d	17 mm
D	40 mm
B	12 mm
d ₁	24.5 mm
D ₂	34.98 mm
r _{1,2} - min.	0.6 mm
d _a - min.	21.2 mm
d _a - max.	24.4 mm
D _a - max.	35.8 mm
r _a - max.	0.6 mm
Basic dynamic load rating - C	10 kN
Basic static load rating - C ₀	4.8 kN
Fatigue load limit - P _u	0.2 kN
Reference speed	38000 r/min
Limiting speed	19000 r/min
Calculation factor - k _r	0.025
Calculation factor - f ₀	13
Category	Single Row Ball Bearings
Inventory	5.0
Manufacturer Name	SKF
Minimum Buy Quantity	N/A



Cylindrical Roller Bearings-VIETNAM C...

Weight / Kilogram	0.069
EAN	7316577758743
Product Group	B00308
Enclosure	2 Metal Shields
Precision Class	ABEC 1 ISO P0
Maximum Capacity / Filling Slot	No
Rolling Element	Ball Bearing
Snap Ring	No
Internal Special Features	No
Cage Material	Steel
Internal Clearance	C0-Medium
Inch - Metric	Metric
Long Description	17MM Bore; 40MM Outside Diameter; 12MM Outer Race Diameter; 2 Metal Shields; Ball Bearing; ABEC 1 ISO P0; No Filling Slot; No Snap Ring; No Internal Special Features
Category	Single Row Ball Bearing
UNSPSC	31171504
Harmonized Tariff Code	8482.10.50.68
Noun	Bearing
Keyword String	Ball
Manufacturer URL	http://www.skf.com
Manufacturer Item Number	6203-2Z
Weight / LBS	0.152
Outside Diameter	1.575 Inch 40 Millimeter
Bore	0.669 Inch 17 Millimeter
Outer Race Width	0.472 Inch 12 Millimeter
bore diameter:	17 mm
static load capacity:	4.75 kN
outside diameter:	40 mm



Cylindrical Roller Bearings-VIETNAM C...

precision rating:	Not Rated
overall width:	12 mm
finish/coating:	Uncoated
bore type:	Round
cage material:	Steel
closure type:	Double Shielded
outer ring width:	12 mm
row type & fill slot:	Single Row Non-Fill Slot
fillet radius:	0.6 mm
internal clearance:	C0
maximum rpm:	19000 RPM
dynamic load capacity:	9.95 kN
series:	62
d_1	24.5 mm
D_2	34.98 mm
d_a min.	21.2 mm
d_a max.	24.4 mm
D_a max.	35.8 mm
r_a max.	0.6 mm
Basic dynamic load rating C	9.95 kN
Basic static load rating C_0	4.75 kN
Fatigue load limit P_u	0.2 kN
Calculation factor k_r	0.025
Calculation factor f_0	13
Mass bearing	0.068 kg